



## TRIPLE TREE INSTALLATION INSTRUCTIONS

V-Rod 8° 49mm

*This product is designed for use on a trike or a bike with a sidecar. Please read instructions fully before starting installation. Refer to your bikes service manual. Warning - Front end performance is a critical safety item. Triple trees should be installed by a qualified service technician.*

1. After the trike rear end is installed. Put the bike in gear and place a block of wood behind the rear wheels. Jack the front end up enough to get the front wheel off of the ground.
2. Remove air box cover.
3. Disconnect the brake line and clutch line from the master cylinders so you can get the lines through the top tree. Plug the holes on the master cylinders so the brake fluid does not leak onto the bike. Remove bolt the holds the brake line "T" to the bottom of the tree, remove the calipers from lower fork tube legs.
4. Disconnect the throttle and idle cables so you can get the cables through the top tree.
5. Remove and disconnect headlight, remove handlebars.
6. Remove front wheel & tire, front fender, Remove the fork tube assemblies.
7. Remove the triple tree.
8. Install fork tube extension (A) in fork tubes.
9. Remove the plastic from around the bearing on the new triple tree. Clean and repack the upper bearing with grease or replace if necessary.
10. Install lower triple tree in neck, install the jam nut on the triple tree stem. Tighten the jam nut (B). The neck bearings need to have more pre-load as a trike. Make sure that the triple tree will turn. If the triple tree will not turn loosen the jam nut(B) a little.
11. Install the top triple tree on stem, use the stock triple tree top nut. Do not tighten at this time.
12. Install fork tubes snug up lower fork tube pinch bolts (C). Do not tighten upper fork tube pinch bolts (D) at this time.
13. Tighten top triple tree nut.
14. Make sure that the fork tubes go through the top tee the same amount. Tighten the upper (D) and lower (C) fork tube pinch bolts.
15. Install handlebars, headlight, wheel & tire, fender and caliper. Hook up brake line and clutch cable and bleed. Hook up throttle and idle cable.



Installation of raked triple tree may change the position of the headlight mount, please check and adjust headlight beam to safe angle.

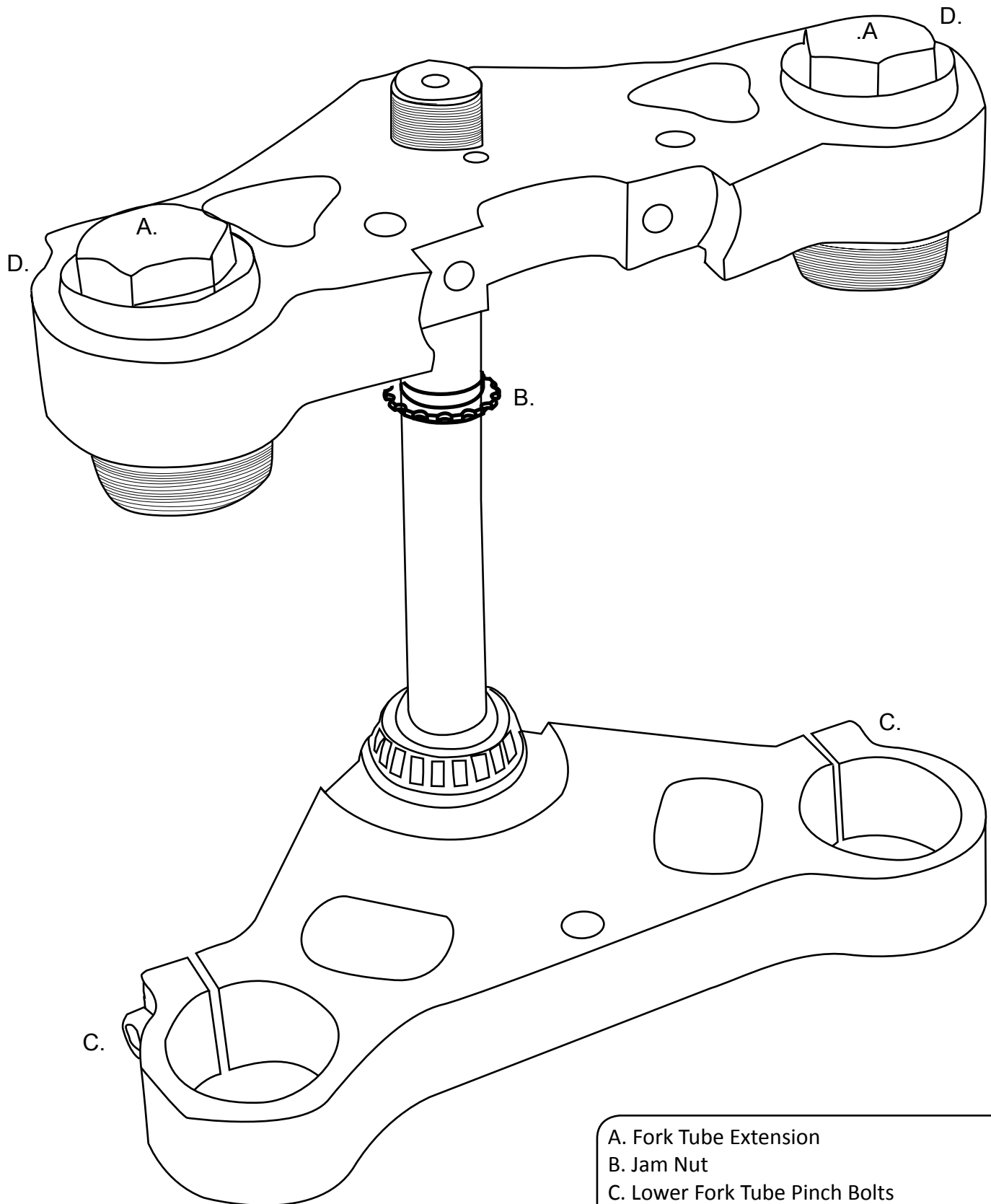

- A. Fork Tube Extension
- B. Jam Nut
- C. Lower Fork Tube Pinch Bolts
- D. Upper Fork Tube Pinch Bolts