



TRIPLE TREE INSTALLATION INSTRUCTIONS

Sportster Custom - SuperLow - Forty-Eight 3° 39mm

This product is designed for use on a trike or a bike with a sidecar. Please read instructions fully before starting installation. Refer to your bikes service manual. Warning - Front end performance is a critical safety item. Triple trees should be installed by a qualified service technician.

1. After the trike rear end is installed. Put the bike in gear and place a block of wood behind the rear wheels. Jack the front of the trike up enough to get the wheel off of the ground.
2. Remove the front caliper. Hang off to the side. Do not remove the brake line from the caliper.
3. Place a heavy blanket over the gas tank as the handle bars will be placed on the gas tank.
4. Remove the front wheel and front fender. Remove headlight hang off to the side. Remove handlebars and place on the blanket. Do not disconnect brake lines, cables or wires.
5. Remove fork tubes. Remove the triple tree.
6. Remove the plastic from around the bearing on the new triple tree. Clean and repack the upper bearing with grease or replace if necessary.
7. Install new triple tree. Do not tighten (part E. triple tree stem pinch bolt) yet.
8. Install fork tubes snug up part (G.lower fork tube pinch bolts). Do not tighten (part F. upper fork tube pinch bolts) yet.
9. Tighten the triple tree stem bolt more than what is for a stock two wheeler. There needs to be more pre load on the neck bearings. Make sure that the triple tree will turn. If the triple tree will not turn loosen the stem bolt a little. Turn the triple tree, if the triple tree turns good tighten up the triple tree stem pinch bolt (E.).
10. Make sure that the fork tubes go through the top tree the same amount.
11. Tighten the upper (F.) and lower (G.) fork tube pinch bolts.
12. Install handle bars, headlight, fender, wheel and caliper.
13. Refer to service manual for torque specifications.



Installation of raked triple tree may change the position of the headlight mount, please check and adjust headlight beam to safe angle.

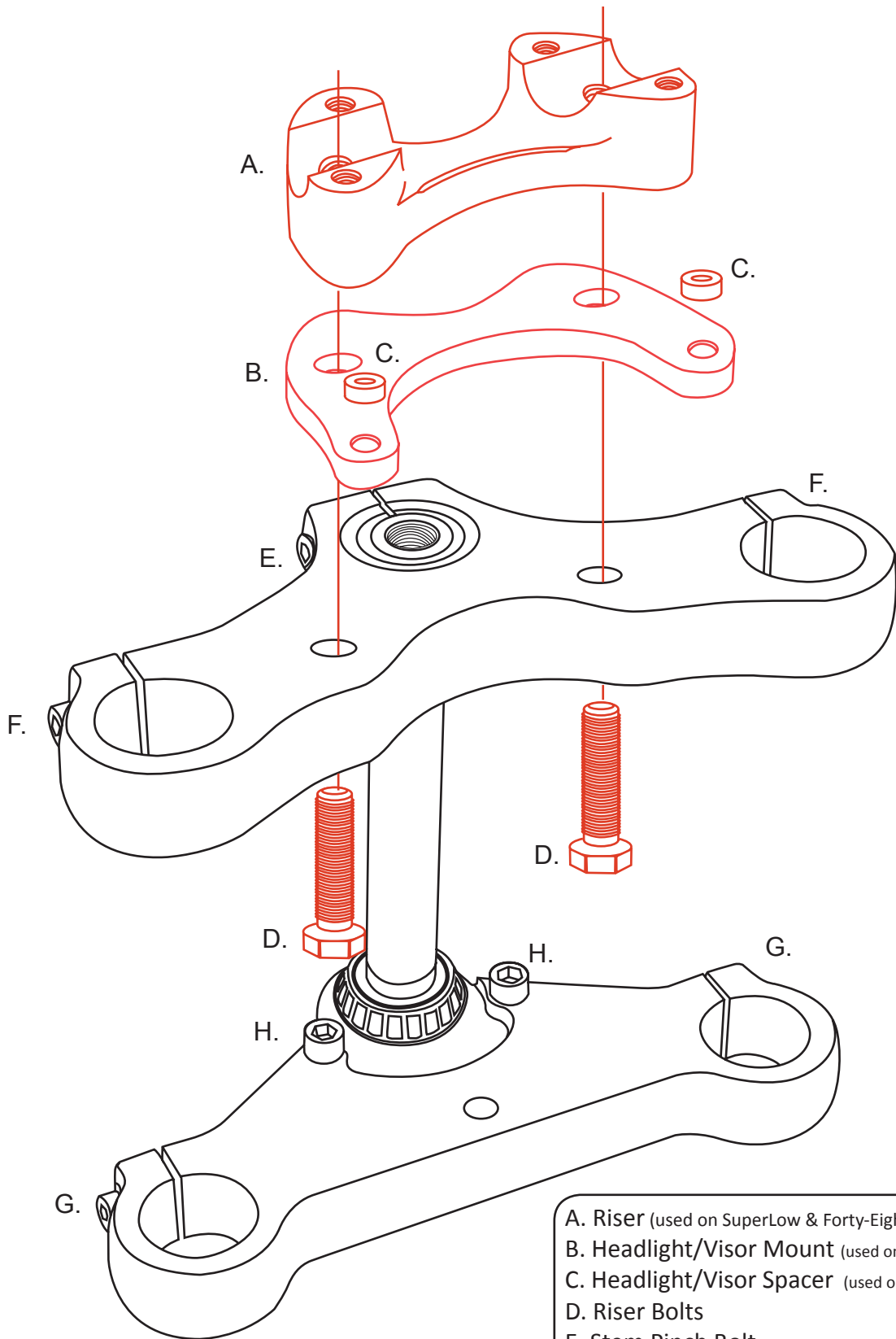

- A. Riser (used on SuperLow & Forty-Eight)
- B. Headlight/Visor Mount (used on SuperLow & Custom)
- C. Headlight/Visor Spacer (used on SuperLow & Custom)
- D. Riser Bolts
- E. Stem Pinch Bolt
- F. Upper Fork Tube Pinch Bolt
- G. Lower Fork Tube Pinch Bolt
- H. Fork Stops